



5SDD 38F2000

Old part no. DV 818-3800-20

Rectifier Diode

Properties

- Industry standard housing
- Suitable for parallel operation
- High operating temperature
- Low forward voltage drop

Key Parameters

V_{RRM}	=	2 000	V
I_{FAVm}	=	3 730	A
I_{FSM}	=	34 000	A
V_{TO}	=	0.915	V
r_T	=	0.088	m Ω

Types

	V_{RRM}
5SDD 38F2000	2 000 V
Conditions:	$T_j = 0 \div 190 \text{ }^\circ\text{C}$, half sine waveform, $f = 50 \text{ Hz}$

Mechanical Data

F_m	Mounting force	$22 \pm 2 \text{ kN}$
m	Weight	0.49 kg
D_s	Surface creepage distance	33 mm
D_a	Air strike distance	20 mm

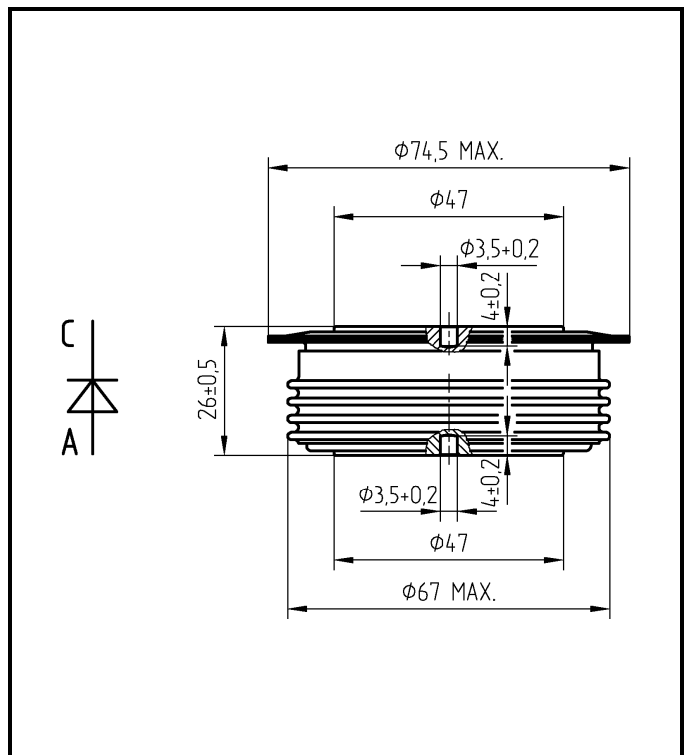

Fig. 1 Case



ABB s.r.o.

Novodvorska 1768/138a, 142 21 Praha 4, Czech Republic

tel.: +420 261 306 250, <http://www.abb.com/semiconductors>

Maximum Ratings		Maximum Limits	Unit	
V_{RRM}	Repetitive peak reverse voltage $T_j = 0 \div 190 \text{ }^\circ\text{C}$	2 000	V	
I_{FAVm}	Average forward current $T_c = 85 \text{ }^\circ\text{C}$	3 730	A	
I_{FRMS}	RMS forward current $T_c = 85 \text{ }^\circ\text{C}$	5 859	A	
I_{RRM}	Repetitive reverse current $V_R = V_{RRM}$	60	mA	
I_{FSM}	Non repetitive peak surge current $V_R = 0 \text{ V, half sine pulse, } T_j = 25 \text{ }^\circ\text{C}$	$t_p = 8.3 \text{ ms}$	42 700	A
		$t_p = 10 \text{ ms}$	40 000	A
	Non repetitive peak surge current $V_R = 0 \text{ V, half sine pulse}$	$t_p = 8.3 \text{ ms}$	36 000	A
		$t_p = 10 \text{ ms}$	34 000	A
$\int I^2 dt$	Limiting load integral $V_R = 0 \text{ V, half sine pulse, } T_j = 25 \text{ }^\circ\text{C}$	$t_p = 8.3 \text{ ms}$	7 577 000	A²s
		$t_p = 10 \text{ ms}$	8 000 000	A²s
	Limiting load integral $V_R = 0 \text{ V, half sine pulse}$	$t_p = 8.3 \text{ ms}$	5 474 000	A²s
		$t_p = 10 \text{ ms}$	5 780 000	A²s
$T_{jmin} - T_{jmax}$	Operating temperature range	0 \div 190	$^\circ\text{C}$	
T_{STG}	Storage temperature range	-40 \div 190	$^\circ\text{C}$	

Unless otherwise specified $T_j = 190 \text{ }^\circ\text{C}$

Characteristics		Value			Unit
		<i>min</i>	<i>typ</i>	<i>max</i>	
V_{T0}	Threshold voltage			0.915	V
r_T	Forward slope resistance $I_{F1} = 5\,969 \text{ A, } I_{F2} = 17\,907 \text{ A}$			0.088	mΩ
V_{FM}	Maximum forward voltage $I_{FM} = 4\,000 \text{ A}$			1.225	V
Q_{rr}	Recovered charge $V_R = 100 \text{ V, } I_{FM} = 2000 \text{ A, } di/dt = -30 \text{ A}/\mu\text{s}$		2 900		μC

Unless otherwise specified $T_j = 190 \text{ }^\circ\text{C}$

Thermal Parameters			Value	Unit
R_{thjc}	Thermal resistance junction to case	double side cooling	15	K/kW
		anode side cooling	24	
		cathode side cooling	40	
R_{thch}	Thermal resistance case to heatsink	double side cooling	4	K/kW
		single side cooling	8	

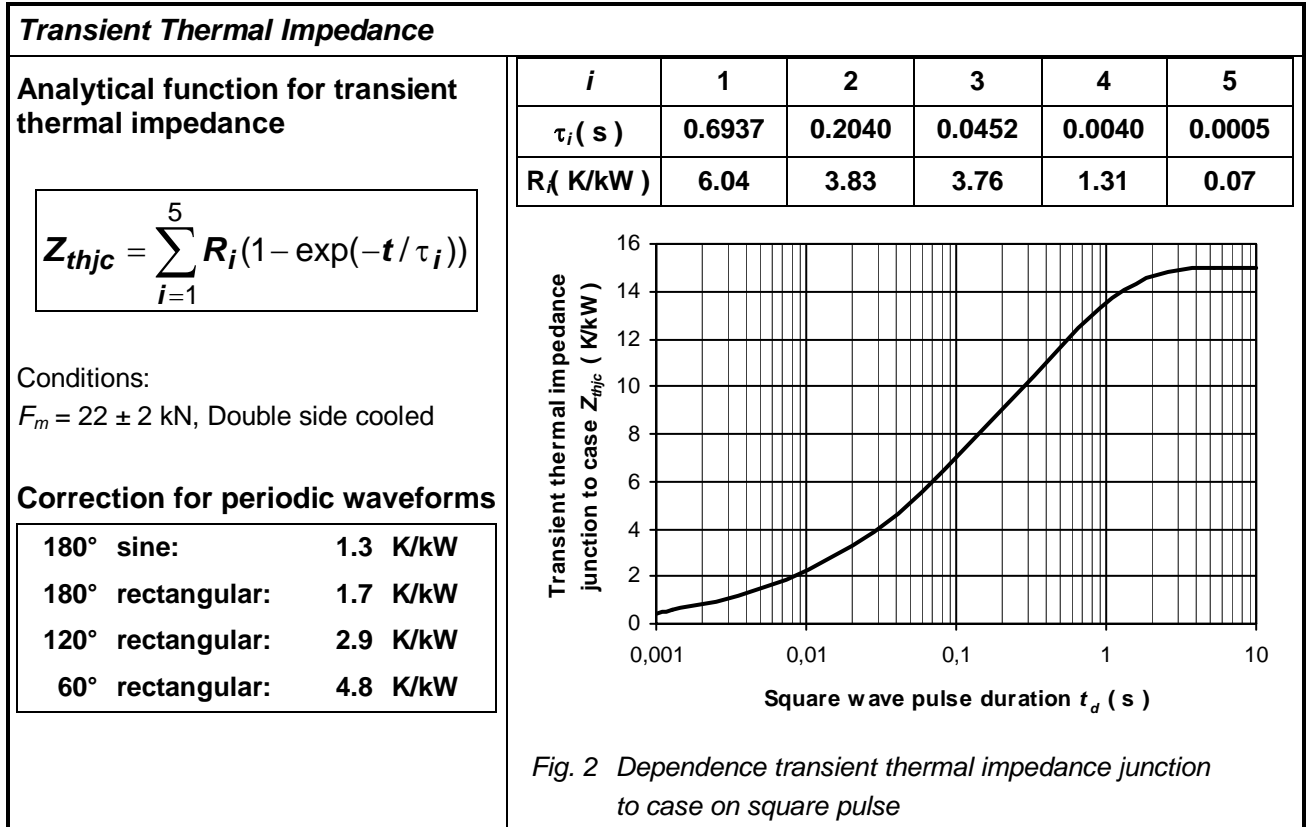

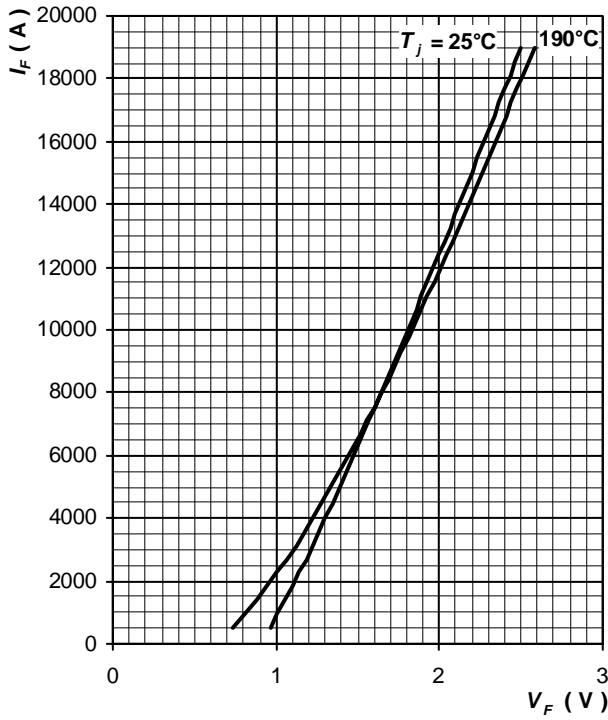

Fig. 3 Maximum forward voltage drop characteristics

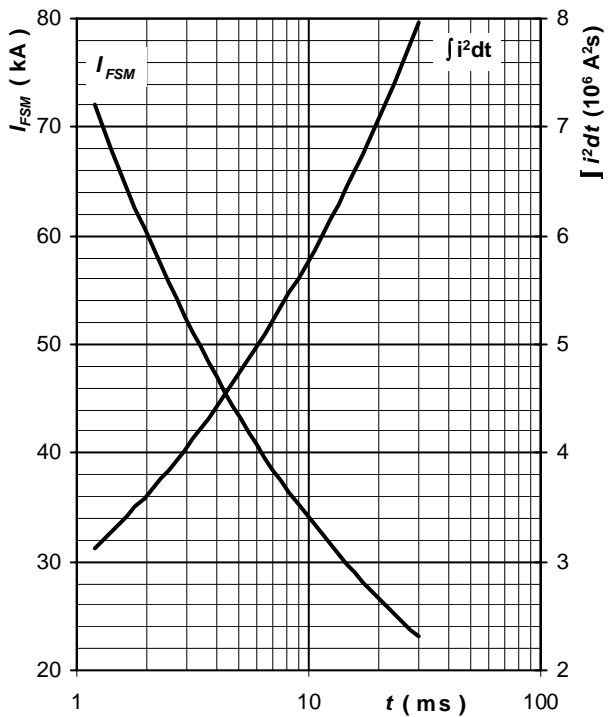

Fig. 4 Surge forward current vs. pulse length, half sine wave, single pulse, $V_R = 0 \text{ V}$, $T_j = T_{jmax}$

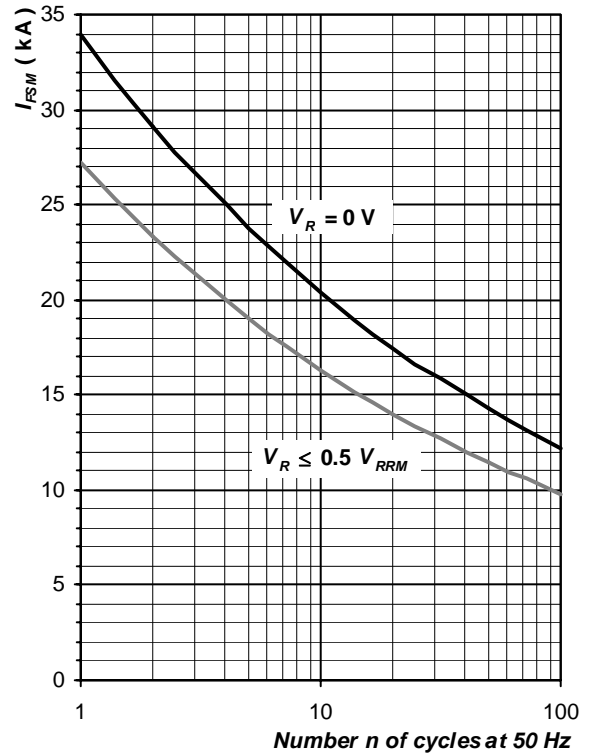

Fig. 5 Surge forward current vs. number of pulses, half sine wave, $T_j = T_{jmax}$

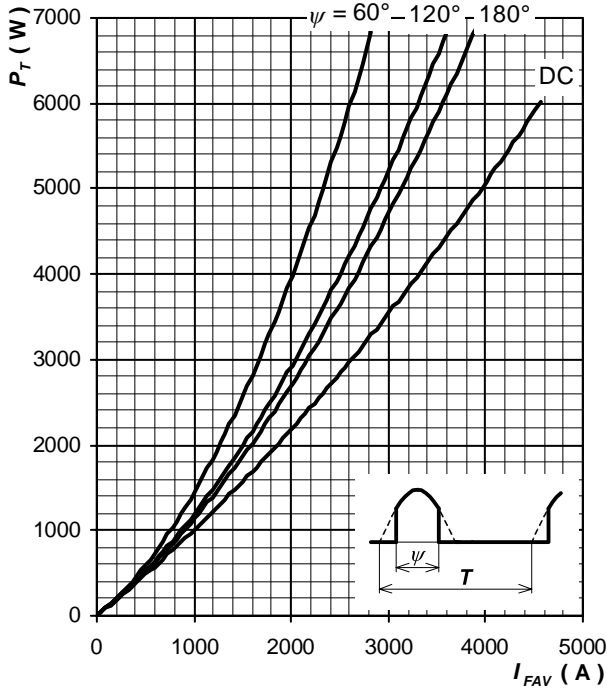

Fig. 6 Forward power loss vs. average forward current, sine waveform, $f = 50 \text{ Hz}$, $T = 1/f$

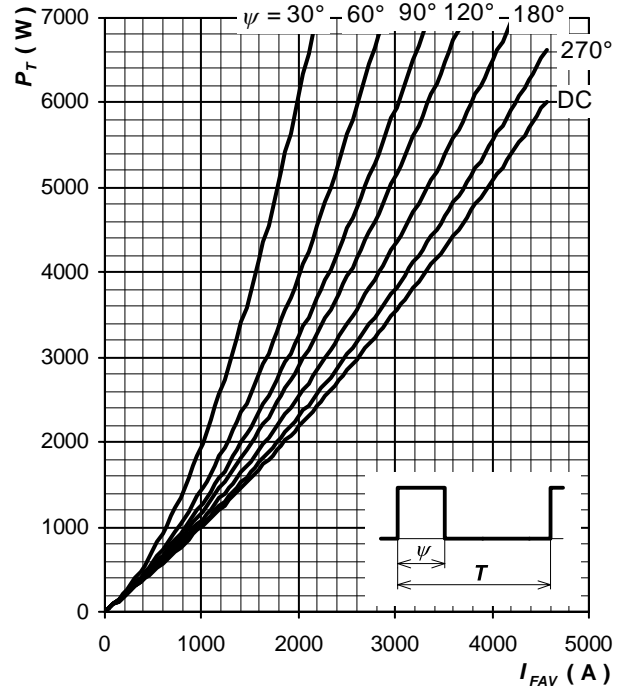

Fig. 7 Forward power loss vs. average forward current, square waveform, $f = 50 \text{ Hz}$, $T = 1/f$

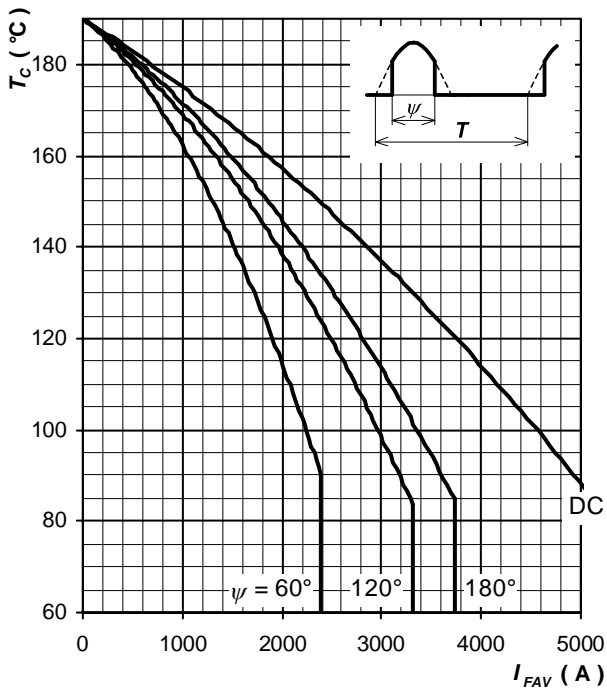

Fig. 8 Max. case temperature vs. aver. forward current, sine waveform, $f = 50 \text{ Hz}$, $T = 1/f$

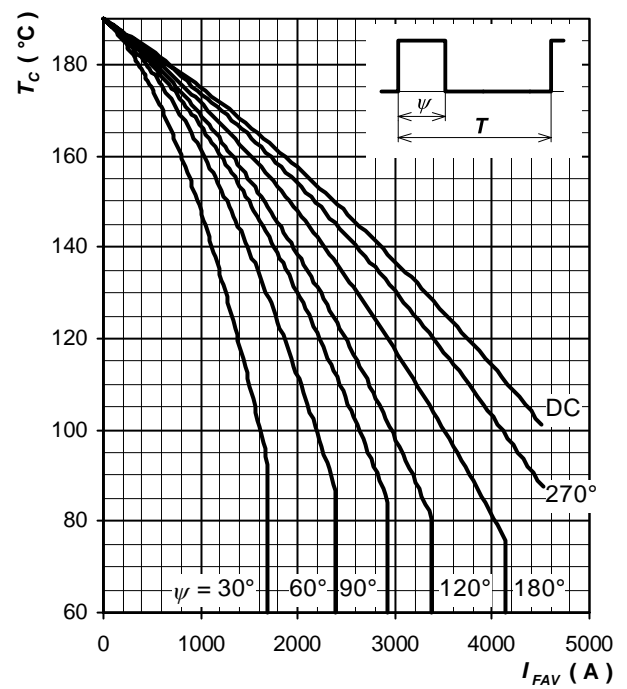

Fig. 9 Max. case temperature vs. aver. forward current, square waveform, $f = 50 \text{ Hz}$, $T = 1/f$

Notes: